



Knee Sleeve: 510100
Knee Heat Exchanger: 520100

Thank you for choosing the Game Ready System. To assure you have the best possible experience please be sure to read the entire User's Manual prior to the use of this product.

Warnings

- Always consult with your physician before using the Game Ready System for any injury. Your physician can determine whether or not the System is appropriate for your injury, and can provide advice on how to best use the System to treat your injury.
- If used incorrectly, cold therapy can cause frostbite or other tissue damage. Always follow the protocol provided by your physician.
- Do not place directly against open wounds, sores, rashes, infections, or stitches. May be applied over clothing or dressing.
- If use of the Game Ready System causes increased pain, swelling, discoloration or loss of sensation, discontinue use and consult with your physician.
- If pressure is uncomfortable, pause unit, and restart with lower pressure.

Care: Gently remove Heat Exchanger from the Sleeve. Hand or machine wash the Sleeve in cold water and mild detergent, or antibacterial soap. Hang to dry. Hand wash the Heat Exchanger, do not machine wash.

Warranty Information:

Sleeve: In case of manufacturer defect, Sleeve may be returned within 7 days of purchase.

Heat Exchanger: 1 year from date of purchase. See warranty card included with Heat Exchanger.



CoolSystems, Inc.
1201 Marina Village Pkwy Suite 200
Alameda, CA 94501
1.888.GAMEREDY

EC REP
EMERGO EUROPE
Molenstraat 15
2513 BH, The Hague
The Netherlands

Straight Knee Wrap Application



While seated, straighten your leg with your heel on the floor or elevated on a table or pillow.

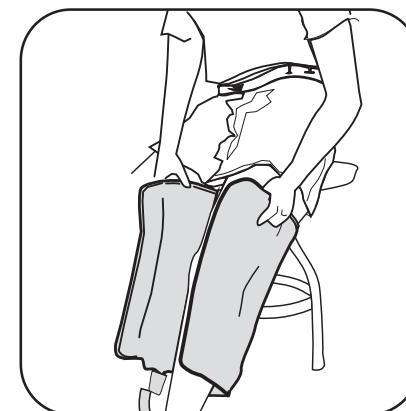

Secure the Wrap snugly around the knee. Connect the hose to the Wrap Or connect the hose to the Wrap first then secure it snugly around the knee.

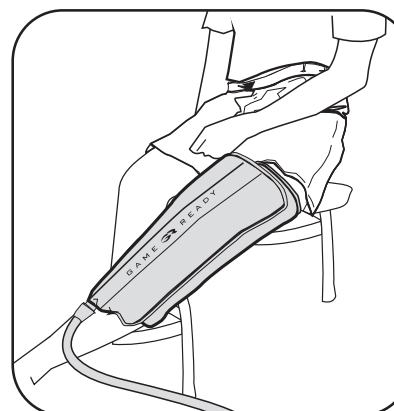

During treatment, keep the leg in an elevated, comfortable position.

After treatment, remove the Wrap from the body before disconnecting the hose.

Caution: Do not open zipper while Wrap is in use, or applied to the body.

Knee Wrap =

Knee Sleeve

+

Knee Heat Exchanger

1

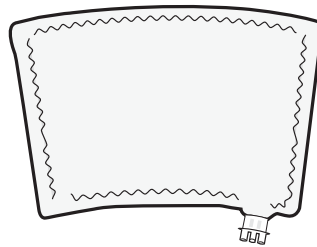
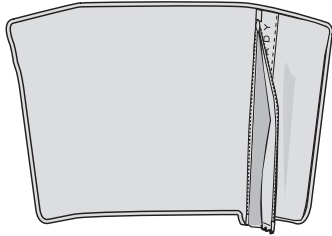

2

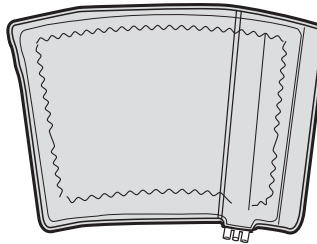
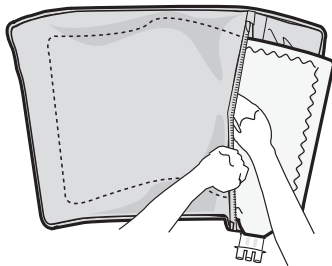

3

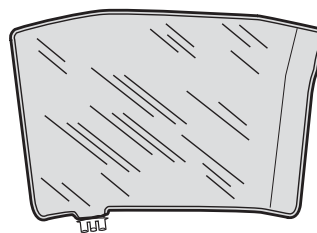
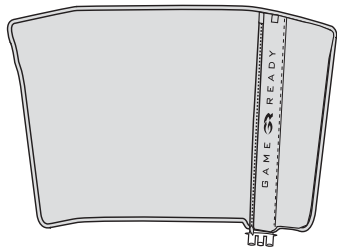

Knee Wrap (Sleeve/Heat Exchanger) - Insertion

fig. 1 Place Sleeve on flat surface with logo side up and open the zipper

fig. 2 Insert Heat Exchanger into the Sleeve with blue side down
(Blue side of Heat Exchanger should match blue side of Sleeve)

fig. 3 Make sure the Heat Exchanger is flat inside the Sleeve with no folds or creases. Zip up the Sleeve. After assembly, lay the blue side up, make sure the Wrap is flat and smooth

Knee Wrap (Sleeve/ Heat Exchanger) - Removal

- 1 Disconnect the Connector Hose from the Wrap
- 2 Unzip the zipper
- 3 Gently pull out the Heat Exchanger